

Smart 50/RS-600 Door Retrofit Controller Upgrade

⚠ WARNING

Disconnect all Electrical Power before Replacing the Door Encoder

IMPORTANT!

Locate packing slip and make sure that all listed parts are enclosed. If not, call your RollSeal distributor immediately. Please read and understand all instructions in this manual before installing Encoder.

Tools Required	Part Numbers	Description	Quantity
Drill Bit -1/4" dia.	6450-6012	/KIT B CS-650 Retro OLD RS-600	This Kit
Drill	6421-4939	/RS-600 Elect Retro Box Assy	1
Phillips Screwdriver bit	6421-4940	/RS-600 ELE RETRO BOX LID ASSY	1
3/4" socket	1004-7002	SCRW Cap 1/2-13x3 Hx HD GR5 Z	1
7/16" socket	1004-7076	SCRW Tek #8x1/2 RD PHIL W HD Z	6
	6421-1404	/RS Encoder Assy w/CB	1
	1903-3059	HRNS RS-600 ENC RETROFIT	1

Description

This kit is used to upgrade from a Smart 50 Controller to an SC-650 Controller for an RS-600 Door. In addition to Kit 6450-6012, a SC-650 Controller is required to replace the Smart 50. The SC-650 Version 1 (6607-8100) is used on RS-600 Doors up to and including 18 feet in height and 18 feet in width. If either the door width or height exceeds 18 feet, the SC-650 Version 2 (6607-8101) is required.

Instructions

STEP 1

Locate the control box for the RS-600 Door in the upper right hand corner of the door and disconnect power to the door. See Figure 1.

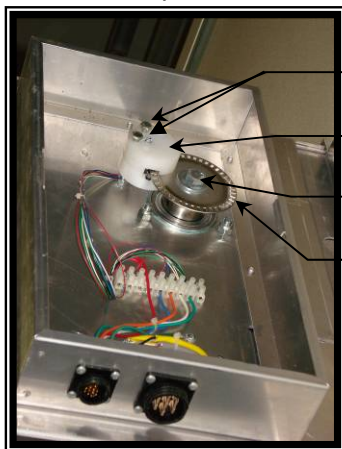

Figure 2 – Old Encoder and Disc

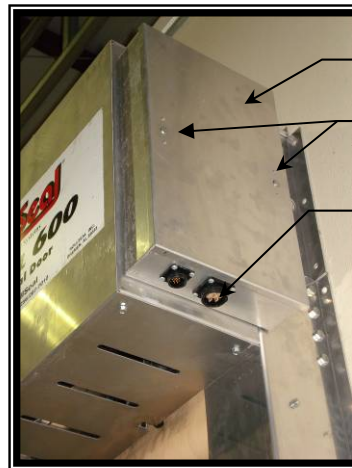

Figure 1 – RS-600 Door Control Box

Control Box
Unlocking
Screws
Unplug Smart
50 Controller

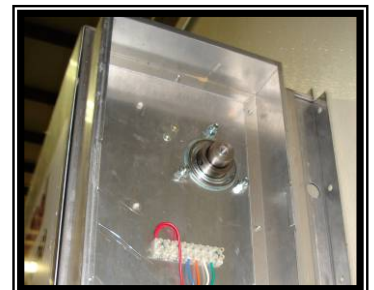

Figure 3 – Old Encoder and Disc Removed

STEP 2

Unplug the Smart 50 Door Controller from the Control box. See Figure 1.

STEP 3

Remove the old Encoder and the Encoder Disc by removing the two 7/16" bolts on the Encoder and the 1/2" bolt on the Encoder Disc. See Figure 2. The control box should appear as in Figure 3 after the old encoder and disc are removed.

STEP 4

Install the Expansion Box (6421-4939) as shown in Figure 4. Push the box flush with the RS-600 Door Head Unit. See Figure 5.

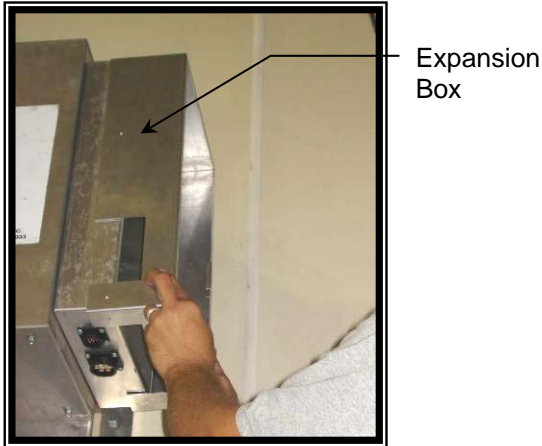

Figure 4 - Install Expansion Box

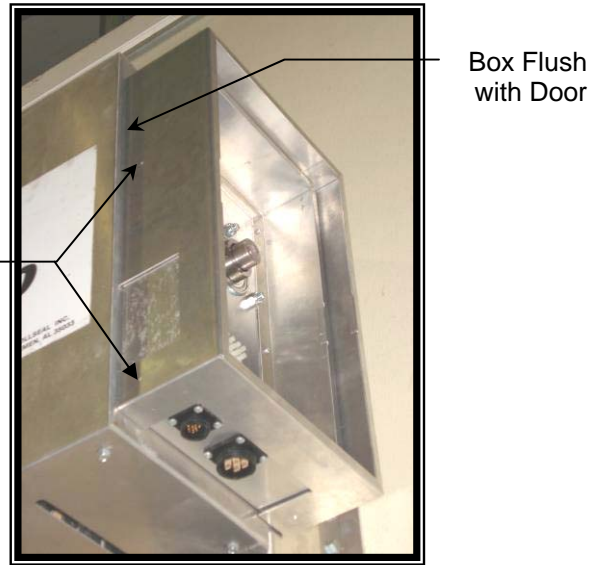

Figure 5 - Expansion Box Flush

STEP 5

Install the Expansion box with pan head screws provided (1004-7076). Use two at the top, two at the front and two at the bottom. See Figure 5.

STEP 6

Remove the paper template attached to this manual and locate over the shaft and mark the location of the elongated bolt. See Figure 6.

Paper Template Drill ¼" hole

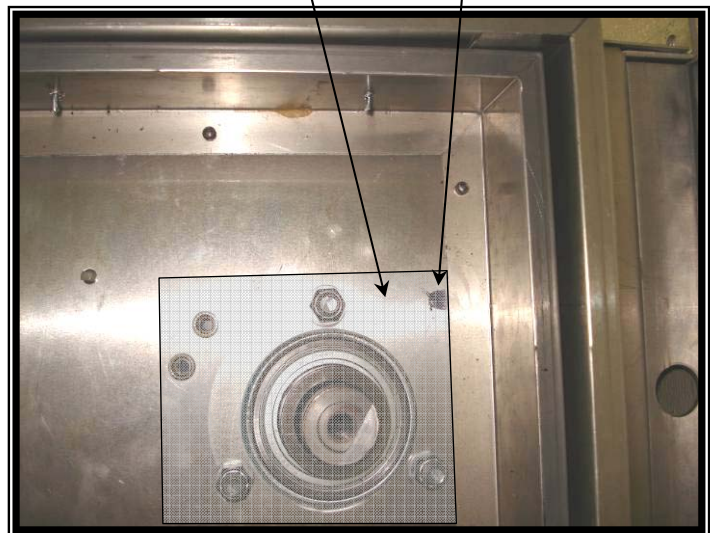

Figure 6 - Locate Paper Template



Figure 7 - Place New Encoder on Shaft

STEP 7

Drill a ¼ " hole for the elongated bolt. See Figure 6.

STEP 8

Remove the Template and Install the Encoder. Fasten with the provided 1/2" bolt (1004-7002). See Figure 7 for encoder orientation.

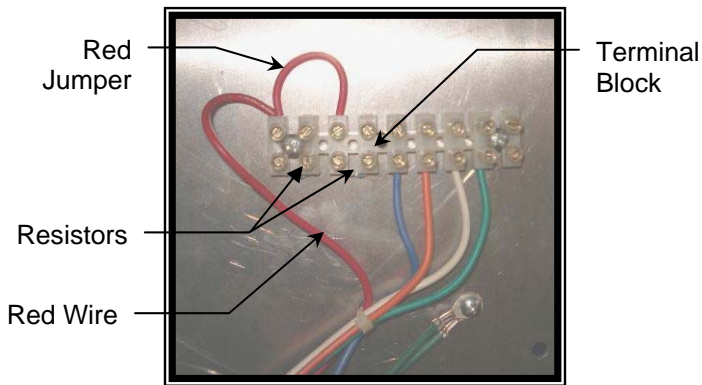

Figure 8 – Existing Terminal Block Wiring

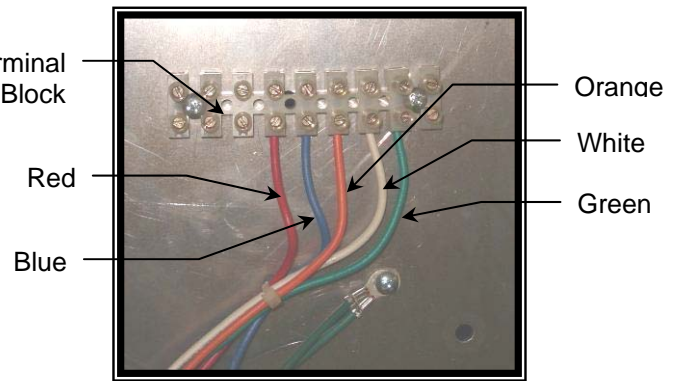

Figure 9 – Terminal Block after Re-Wiring

STEP 9

See Figure 8. Remove the red jumper and the two resistors. Relocate the red wire as shown in Figure 9.

STEP 10

Install provided harness (1903-3059) as shown in Figure 10 and wire as shown in Figure 11.

STEP 11

If only installing encoder on RS 600 door, skip this step. Install the SC-650 Controller and verify Operation. See Figure 12. Refer to the 4801-5156 SC-650 Controller manual.

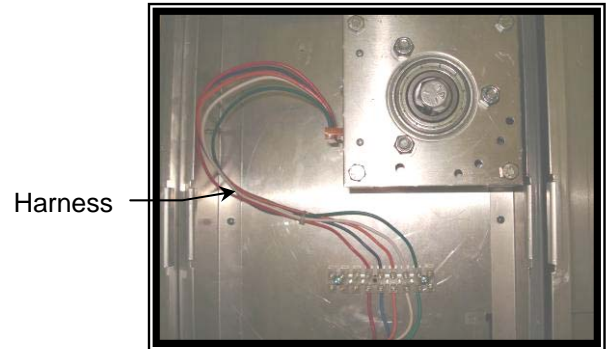

Figure 10 – Terminal Block with Harness

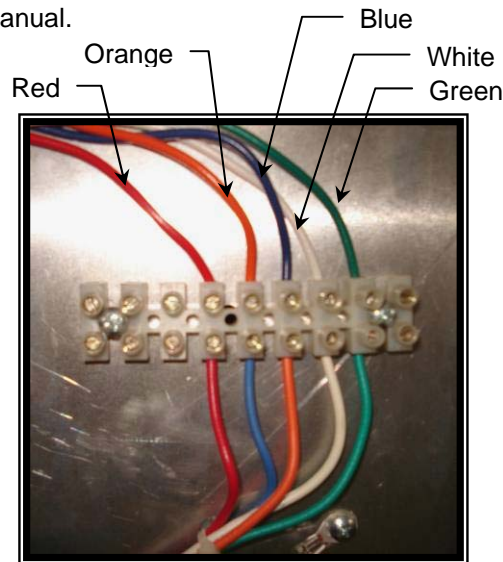

Figure 11 – Harness Wiring



Figure 12 – Install Harness



Figure 13 – Install Door

STEP 12

Install the Control Box Door. See Figure 13.

STEP 13

Installation complete.



Smart 50/RS-600 Door Retrofit Controller Upgrade